

KEY LEGEND: ○

- ADD PATCH/REPAIR AS NECESSARY OR REQUIRED DRYWALL ON P.T. 1X2 STRIPS @ EXIST. 8" CMU WALL. DRYWALL SHALL BE TAPED, SANDED & READY FOR "TENANT" FINISHES.
- ADD 1/2" DRYWALL ON P.T. 1X2 STRIPS @ EXIST. COLUMNS, RETURN INTO JAMBS, RUN MIN. 6" ABOVE CLG. HEIGHT. DRYWALL SHALL BE TAPED, SANDED & READY FOR "TENANT" FINISHES.
- TYP. PARTITION W/1/2" DRYWALL EA. SIDE OF 3 3/8" 25 GA. STEEL STUDS @ 16" O.C. +10'-6" A.F.F. (AT KITCHEN OR BATHROOM SIDE USE 1/2" GREENBOARD)
- FURR WALL OUT AS REQ. FOR NEW PLUMBING. RUN FROM FLOOR TO 6" ABOVE CLG.
- 1/2" GYP BD. ON EACH SIDE OF 1 1/2" 25 GA. STL. STUD @ 16" O.C. (1/2" GREENBOARD ON 25 GA. STL. STUDS @ 12" O.C. IN BATHROOM AREA) SEE DETAIL 4/A7
- SAME AS "3" EXCEPT RUN PARTITION & DRYWALL TO ROOF DECK.
- 1/2" DUROCK +3'-0" & 1/2" GREENBOARD FROM DUROCK TO CLG., 1/2" DRYWALL FROM CLG TO ROOF DECK ON 20 GA. 6" STEEL STUDS @ 16" O.C.
- +3'-0" HIGH PLANTER DIVIDING WALL W/1/2" DRYWALL EA. SIDE OF 25 GA. 3 3/8" STL. STUDS @ 16" O.C.
- 1/2" DUROCK (PASTA COOKING SIDE) FROM FLOOR TO TOP OF PARTITION (+3'-0" A.F.F.) & WITH 1/2" GREENBOARD (DINING ROOM SIDE) ON 3 3/8" STEEL STUDS @ 16" O.C.
- +5'-0" HIGH PARTITION W/1/2" GREENBOARD EA. SIDE OF 25 GA. 3 3/8" STL. STUDS @ 16" O.C. & 6" WIDTH @ ENDS TO STRUCTURE ABOVE FOR STABILITY
- SAME AS "7" EXCEPT RUN ONE END TO STRUCTURE ABOVE
- +3'-0" HIGH WING WALL W/1/2" DRYWALL EA. SIDE OF 25 GA. 3 3/8" STL. STUDS @ 16" O.C.
- BOX-IN EXIST. COLUMN W/1/2" DRYWALL ON 1 1/2" STL. STUDS, RUN ENCLOSE FLOOR TO 6" ABOVE CEILING.
- EXISTING 1 HR. RATED DEMISING WALL, ADD 1/2" GREENBOARD FROM FLOOR TO CEILING ENTIRE WALL, MAINTAIN SEPARATION BETWEEN TENANTS
- EXISTING PARTITION. PATCH/REPAIR DRYWALL AS REQUIRED. DO NOT DISTURB ELECTRICAL PANELS
- NEW STOREFRONT SYSTEM TO MATCH BLDG. STANDARD. SEE DETAIL SHEET A-5
- SEE MILLWORK DRAWINGS FOR COMPLETE DETAILS OF CABINETS & COUNTERS
- "BOBRICK" OR EQUAL BATHROOM COMPARTMENT W/ADA COMPLIANT DOORS, SUBMIT SHOP DRAWINGS FOR APPROVAL

FINISH LEGEND: □

- PROVIDE & INSTALL 18"x18" CERAMIC FLOOR TILE THROUGHOUT DINING AREA, BATHROOMS & GAMEROOM
- PROVIDE & INSTALL 6"x6" QUARRY TILE THROUGHOUT SERVICE, KITCHEN & POT/DISH AREA
- 5" TILE BASE (TO MATCH 18"x18" FLOOR TILE) THROUGHOUT DINING AREA, BATHROOM & GAMEROOM.
- 5" TILE BASE THROUGHOUT SERVICE AREA, KITCHEN & POT/DISH AREA. COLOR TO MATCH QUARRY TILE. VERIFY W/OWNER EXACT TILE SPEC. & PATTERN. PROVIDE \$2.00 ALLOWANCE (FOR TILE ONLY)
- (1) COAT OF PLASTER W/LIGHT TEXTURE. PAINT "WHITE" FROM TOP OF BASE TO CEILING
- MARLITE PLANK-WOODGRAIN PLANK PRODUCT NO. PLK-321-S2 (NATURAL OAK PRINT) WAINSCOT W/(1) COAT ABOVE TO CEILING OR TO TOP OF PARTITION, SEE KEY LEGEND FOR WALL HEIGHT.
- SAME AS "F" EXCEPT W/MIRROR ABOVE MARLITE TO CEILING
- MARLITE FRP-PEBBLE SURFACE (FRP-P140) "WHITE" FROM TOP OF BASE TO CEILING
- 4"x4" WALL TILE FROM FLOOR TO CEILING, PROVIDE \$2.00 ALLOWANCE FOR TILE ONLY. LABOR & MATERIAL SHALL BE PART OF BID. OWNER TO DETERMINE COLOR OF TILE.
- 4"x4" WALL TILE EA. SIDE (SEE LEGEND FOR WALL HEIGHT) PARTITION
- 2'x2' ACOUSTICAL TILE CEILING, "UGS" OR APPROVED EQUAL, WHITE W/ WHITE GRID, HUNG +10'-0" A.F.F. PER MFG. SPECS., PROVIDE \$2.50 S.F. ALLOWANCE INSTALLED

ALL INTERIOR FINISHES SHALL MATCH "BELLANTE'S" BUILDING STANDARD, VERIFY EXACT, FLOOR & WALL COVERINGS W/OWNER

MAXIMUM OF 1/2" DIFFERENCE IN LEVEL BETWEEN OPPOSITE SIDES OF ALL EXIT DOORS IN ACCORDANCE WITH NFPA 101 5-2.1.3.3

SEE DOOR SCHEDULE & DETAILS SHEET A-4

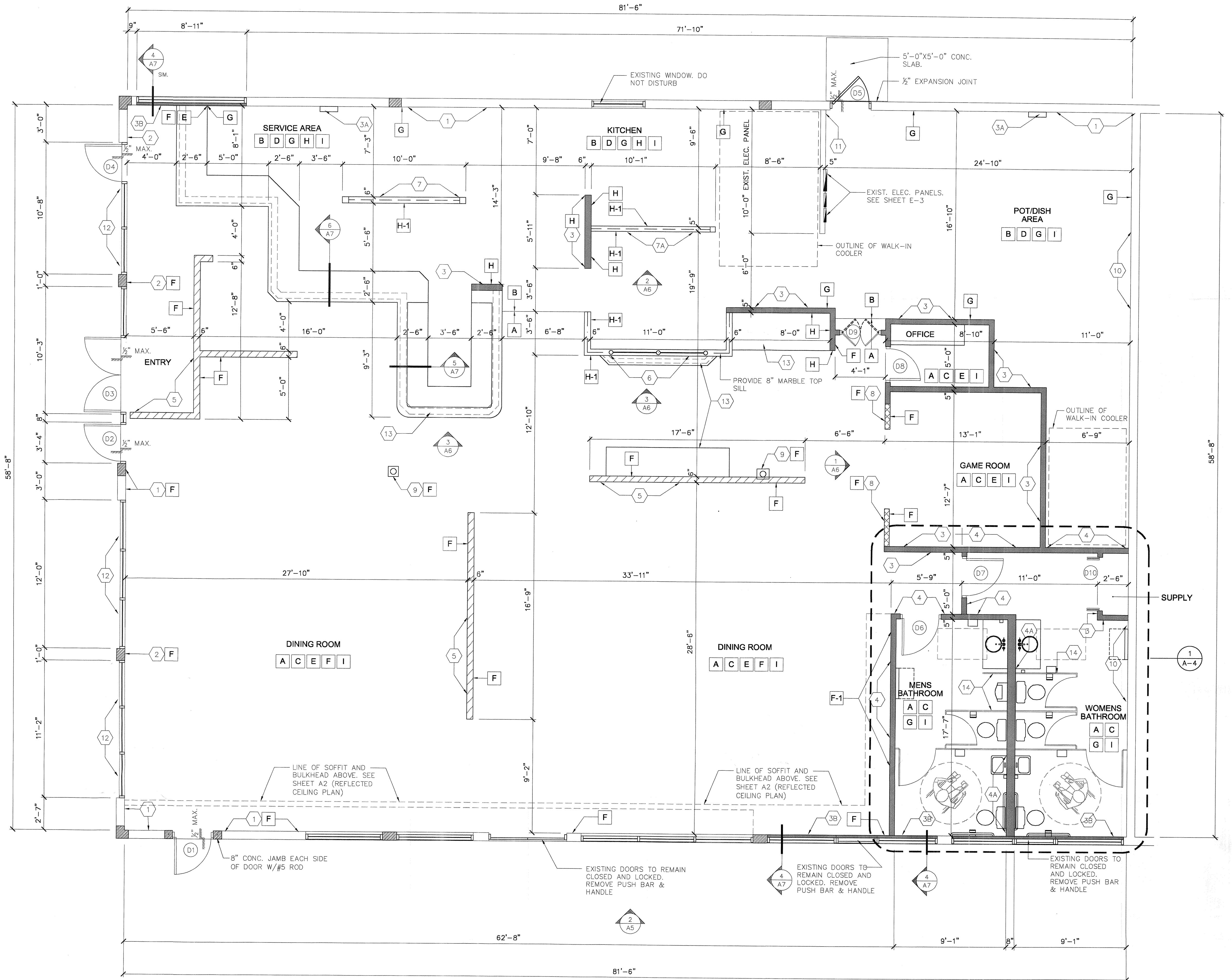

FLOOR PLAN
Scale: 1/4" = 1'-0"

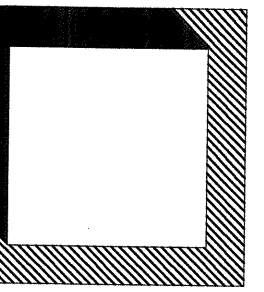

william
hamilton
arthur
architect
inc.

800 douglas entrance
suite 303
coral gables,
florida, 33134
(305)443-3100
fax (305)441-7960
license no. 2282

DRAWN BY:
J.P.

SEAL:

FLOOR PLAN
KEY LEGEND
FINISH LEGEND

BELLANTE'S
PAMBLEWOOD PLAZA
8355 WEST ATLANTIC BLVD
CORAL SPRINGS, FLORIDA
OWNER: DENNIS WACHNA (954) 303-8631

REVISION DATE(S)



PROJ. NO: 01-18 DATE: 4/10/01

SHEET NO:

A1
4 of 24